

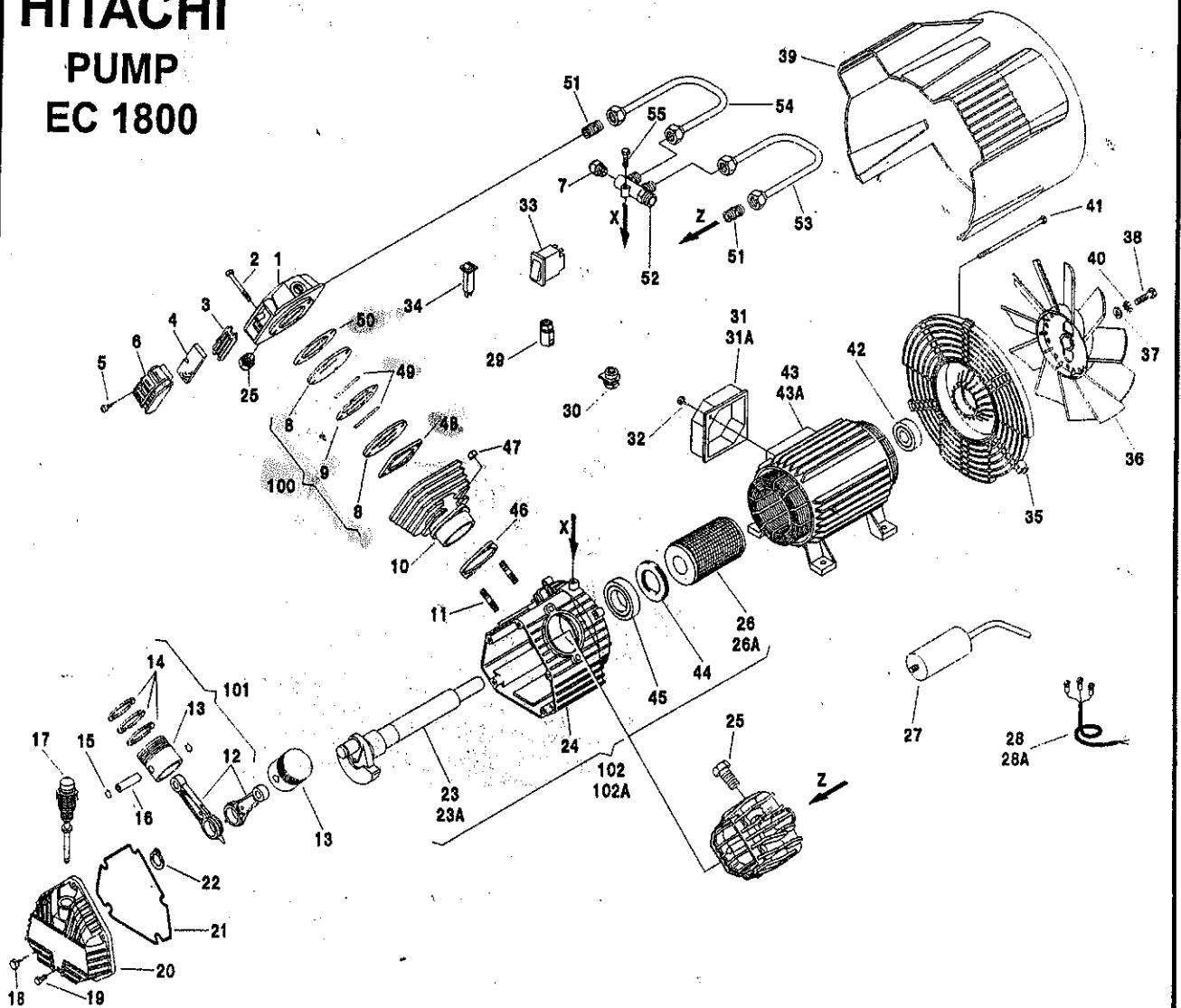

# HITACHI

## PUMP

### EC 1800



REF. RIF.	CODE CODICE	QT	DESCRIPTION DESCRIZIONE	REF. RIF.	CODE CODICE	QT	DESCRIPTION DESCRIZIONE
1	7570090000	2	Head - Testa	31A	7382350000	1	Three phase cover - Coperchio trifase
2	7011220000	8	Screw - Vite T.E. M6x40 UNI 5737	32	7012020000	2	Screw - Vite ø 3.9x12.7 UNI 6954
3	7458340000	2	Filter plate - Piastrina filtro	33	7410530000	1	3ph. thermal protection - Termica trifase
4	7210010000	2	Filtering element - Elemento filtrante	34	7410390000	1	1ph. thermal protection - Termica monofase
5	7012100000	2	Screw - Vite ø 3.9x19 "B" UNI 6954	35	7640010000	1	Cover - Calotta
6	7210180000	2	Intake filter - Filtro aspirazione	36	7200020000	1	Fan - Ventola
7	7196000000	1	START valve - Valvola START	37	7038020000	1	Washer - Rondella
8	7458020000	4	Valve plate - Piastra portavalvole	38	7011090000	1	Screw - Vite T.E. M8x20 UNI5739
9/46				39	7150370000	1	Housing - Carenatura
48/50	4082080000	2	Set of gasket - Kit guarnizioni <i>Dichtungssatz</i>	40	7031010000	1	Washer - Rondella ø 8 UNI 3703
10	5060160008	2	Cylinder - Cilindro	41	7015100000	4	Tension rod - Tirante
11	7015020000	4	Stud bolt - Prigioniero	42	7060030000	1	Bearing - Cuscinetto 6204 2RS
12	5050160008	2	Con rod - Biella	43	4011450000	1	Motor - Motore V230-50/1
13	7220050000	2	Piston - Pistone	43A	4011340000	1	Motor - Motore V400-50/3
14	4080030000	2	Piston rings - Kit segmenti	44	7071030000	1	SMIM ring - Anello SMIM 3462/10
15	7041030000	4	Ring - Anello	45	7060070000	1	Bearing - Cuscinetto 6007
16	7050030000	2	Piston pin - Spinnotto	47	7020070000	4	Nut - Dadoo M8 UNI 5587
17	4070010000	1	Oil level - Asta livello olio	49	4081010000	1	Set of valve - Kit valvole
18	7012180000	5	Screw - Vite T.E. M6x20 TAP - TITE	51	7081100000	2	Joint - Raccordo
19	7011460000	1	Screw - Vite T.E. M6x15 TAP - TITE	52	7089950000	1	Manifold - Collettore
20	7650010000	1	Carter cover - Coperchio carter	53	7237010000	1	Tube dx. - Tubo dx.
21	7078440000	1	Gasket - Guarnizione	54	7237020000	1	Tube sx. - Tubo sx.
22	7040040000	1	Seeger - Seeger E 20 UNI 7435	55	7010120000	1	Screw - Vite T.C.C.E. M6x25 UNI5931
23	5040510008	1	Single phase shaft - Albero monofase				
23A	5040520008	1	Three phase shaft - Albero trifase				
24	5070180008	1	Carter - Carter				
25	7090080000	2	Plug - Tappo	100	4082730000	1	Set Plates/Valves - Kit Piastra/Valvole
26	5090220008	1	Single phase rotor - Rotore monofase	101	4191040000	1	Set Con rod/Piston - Kit Biella/Pistone
26A	5090250008	1	Three phase rotor - Rotore trifase	102	4280280000	1	Carter/Single phase Shaft unit - Gruppo Carter/Albero monofase
27	7310410000	1	Capacitor - Condensatore 50 µF	102A	4280290000	1	Carter/Three phase Shaft unit - Gruppo Carter/Albero trifase
28	7329900000	1	Single phase cable - Cavo monofase				
28A	7329870000	1	Three phase cable - Cavo trifase				
29	7501050000	1	Stretch eliminator - Bloccacavo steab				
30	7501060000	1	Stretch eliminator - Bloccacavo				
31	7382340000	1	Single phase cover - Coperchio monofase				

VALID FROM 12/12/2003 - VALIDO DAL 15/12/2003 (REV.01.N.03)