

HITACHI

LIST NO. 0340

ELECTRIC TOOL PARTS LIST

■ ORBITAL SANDER
Model SV 12V

2001·6·1
(E3-1)

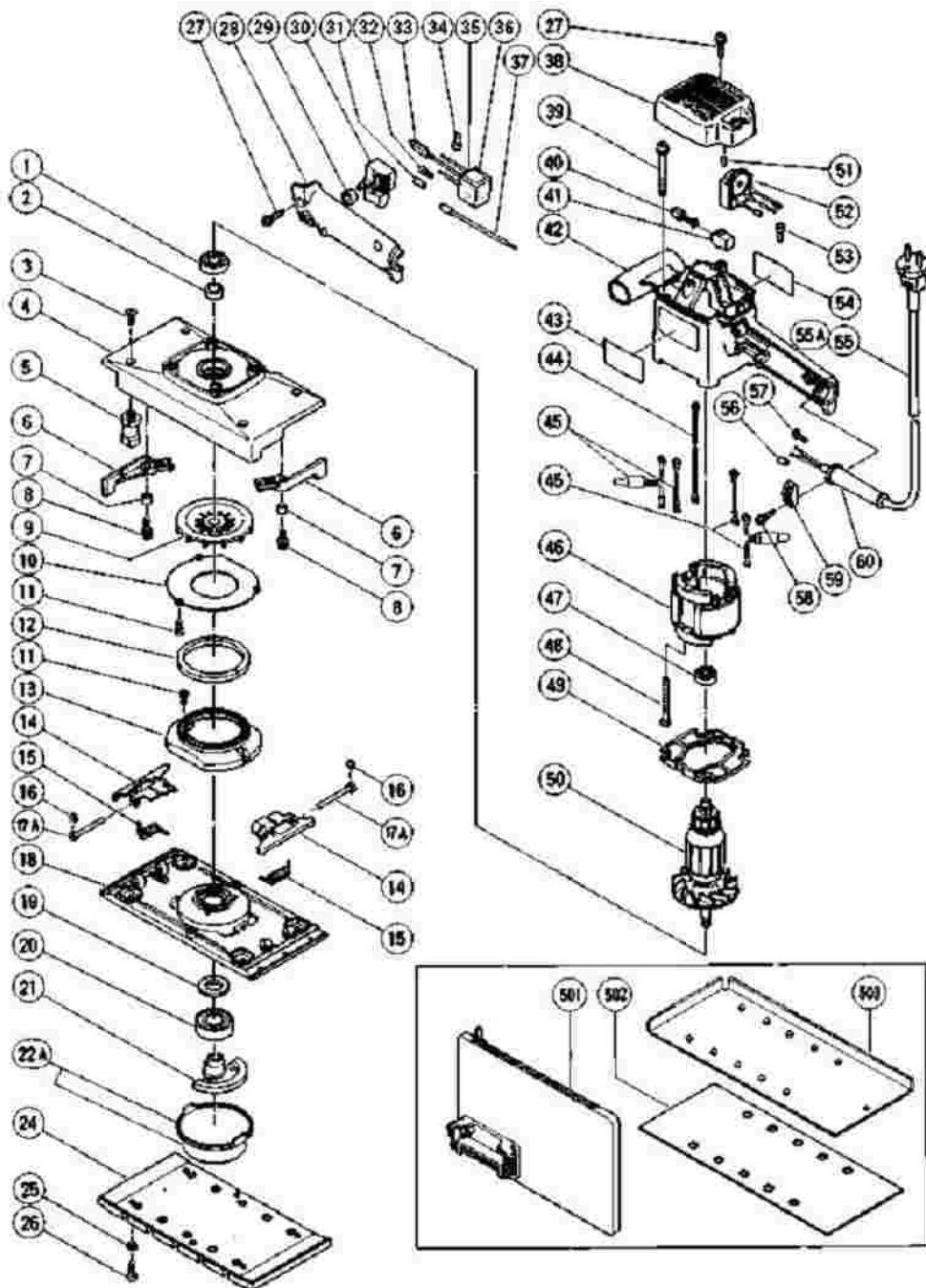

SV12V

| Pos. Nr. | Art. Nr. | Beschreibung | Stueck | Kommentar | Bes |
|----------|----------|-----------------------------------|--------|-------------|----------------------------|
| 1 | 600-1DD | KUGELLAGER 6001 DD | 1 | | BAL BEA 6001 |
| 2 | 300-158 | BUCHSE SV12V/SV12SD | 1 | | SLEE |
| 3 | 992-013 | +SENKKOPFSCHRAUBE M5X14 SELBSTSI. | 4 | | SEAL FLAT SCRE |
| 4 | 300-172 | RAHMEN SV12V/SV12SD | 1 | | FRA |
| 5 | 300-317 | GUMMIFUSS SV12V/SV12SD | 4 | | RUB |
| 6 | 300-161 | HEBEL SV12V/SV12SD | 2 | | LEVI |
| 7 | 953-066 | ABSTANDSTÜCK SV12SD/V/SB110 | 2 | | DIST PIEC |
| 8 | 993-539 | +KOPFSCHRAUBE M4X16 M.U.SCHEIBE | 2 | | MAC SCRI (W/W M4X |
| 9 | 300-159 | LÜFTER SV12V/SV12SD | 1 | | FAN |
| 10 | 300-160 | LUFTFÜHRUNG SV12V/SV12SD | 1 | | DUS GUI |
| 11 | 949-216 | +KOPFSCHRAUBE M4X10 (10ST) | 5 | | MAC SCRI (10 P |
| 12 | 300-165 | FILZ (A) SV12V/SV12SD | 1 | | FELT |
| 13 | 300-164 | STAUBFÜHRUNG SV12V/SV12SD | 1 | | DUS |
| 14 | 300-162 | PAPIERHALTER SV12V/SV12SD | 2 | | PAPE HOL |
| 15 | 953-320 | FEDER SV12SD/SV12V | 2 | | SPRI |
| 16 | 872-971 | SICHERUNGSRING (E-TYP) D3 | 2 | TILL 6.1998 | RETA RINC FOR |
| 17A | 316-549 | HALTESTAB SV12SD/V | 2 | | HOL |
| 18 | 300-173 | GRUNDPLATTE SV12V/SV12SD | 1 | | BOT PLAT |
| 19 | 300-166 | FILZ SV12V/SV12SD | 1 | | FELT |
| | | | | | |

| | | | | | |
|-----|----------|---|---|------------------------------|-----------------------------|
| 20 | 620-3DD | KUGELLAGER 6203 DD | 1 | | BAL BEA 6203) |
| 21 | 300-167 | GEGENGEWICHT SV12V/SV12SD | 1 | | BAL WEIC |
| 22A | 300-318 | DECKEL SV12V/SV12SD | 1 | | COV |
| 24 | 300-090 | SCHLEIFPLATTE GELOCHT SV12V/SD | 1 | | SANI (PER |
| 25 | 949-454 | FEDERSCHEIBE M5 (10ST) | 6 | | SPRI WAS (10 P |
| 26 | 949-238 | +KOPFSCHRAUBE M5X14 (10ST) | 6 | | MAC SCRI (10 P |
| 27 | 982-095 | SCHNEIDSCHRAUBE D4X20 M.U-SCHEIBE | 4 | | TAP SCRI (W/W D4X2 |
| 28 | 300-157 | HANDGRIFFDECKEL SV12V/SV12SD | 1 | | HAN COV |
| 29 | 940-811 | HALTER SV12V/SV12SD | 1 | | PUSH HOL |
| 30 | 957-747 | SCHALTER CR10V/CR12V/u.a. | 1 | | SWIT SCRI W/LC |
| 30 | 971-667Z | SCHALTER CM6/CR10V/CR12V/D13/u.a. | 1 | | SWIT PILL W/LC |
| 31 | 981-373 | ADERENDHÜLSE (D) DIV.TYPEN | 2 | FOR NOISE SUPPRESSOR | TUBI |
| 32 | 980-063 | KABELSCHUH C7U/CJ65V2/H70SA/G13V | 1 | FOR NOISE SUPPRESSOR | TERM |
| 33 | 992-635 | ERDKLEMME DW15Y/SV12V u.a. | 1 | FOR NOISE SUPPRESSOR | EAR TERM |
| 34 | 959-140 | VERBINDER 50091 (10ST) DIV.TYPEN | 1 | FOR USA | CON 5009 |
| 35 | 994-273 | KONDENSATOR DIV.TYPEN | 1 | | NOIS SUPE |
| 36 | 930-153 | POLSTER (B) SELBSTKLEB. DIV.TYPEN | 1 | FOR NOISE SUPPRESSOR | SUPE |
| 36 | 963-243 | POLSTER (SELBSTKLEBEND) DIV.TYPEN | 1 | FOR NOISE SUPPRESSOR FOR NZL | SUPE |
| 37 | 300-185 | VERBINDERKABEL SV12V | 1 | FOR EUROPE | INTE WIRI |
| 38 | 300-183 | GEHÄUSEDECKEL SV12V | 1 | | TOP |

| | | | | | |
|----|----------|-----------------------------------|---|--|----------------------|
| 39 | 300-319 | +KOPFSCHRAUBE M5X60 | 4 | | MAC SCRI M5X |
| 40 | 999-041 | KOHLLENBÜRSTEN (PAAR) | 2 | | CAR BRU PAIR |
| 41 | 930-483 | KOHLLENHALTER DW15Y/W6VA1 u.a. | 2 | | BRU HOL |
| 42 | 300-154 | GEHÄUSE SV12V/SV12SD | 1 | | HOU |
| 43 | 300-184 | "AUFKLEBER ""HITACHI"" SV12V" | 1 | | HITA LABI |
| 44 | 300-179 | VERBINDERKABEL SV12V/SV12SD | 1 | | INTE WIRI |
| 44 | 300-180 | | 1 | FOR USA | INTE WIRI |
| 45 | 301-523 | DROSSEL SV12V | 2 | | CHO |
| 45 | 301-843 | | 2 | FOR USA | INTE WIRI |
| 46 | 340-156C | | 1 | | STAT 115V |
| 46 | 340-156G | | 1 | FOR SWE,AUT,NOR | STAT 230V |
| 46 | 340-156F | STATOR 230-240V SV12V/SD | 1 | FOR FRG | STAT 240V |
| 46 | 340-156H | | 1 | FOR GBR,ITA,FRA,HOL,DEN,FIN,NOR,SUI | STAT 240V |
| 46 | 340-156J | | 1 | FOR GBR | STAT |
| 47 | 608-VVM | KUGELLAGER 608 VVM | 1 | | BALI BEAL 608V |
| 48 | 953-174 | SCHNEIDSCHRAUBE D5X55 | 2 | | HEX. TAPI SCRI |
| 49 | 300-155 | LUFTFÜHRUNG SV12SV/SV12SD | 1 | | FAN |
| 50 | 360-124U | | 1 | INCLUD.1,47 | ARM ASS" 115V |
| 50 | 360-124E | ANKER 220V-230V SV12V/SD | 1 | | ARM 220V |
| 50 | 360-124F | | 1 | FOR NZL | ARM 230V |
| 51 | 946-362 | LAGERVERRIEGELUNG (DIV.TYPEN) | 2 | | BEAL LOCI |

| | | | | | |
|-----|----------|-----------------------------------|---|--|---------------------|
| 52 | 300-187 | DREHZAHLREGLER SV12V | 1 | | CON' CIRC 240V |
| 52 | 300-186 | DREHZAHLREGLER FSV13Y/SV12V | 1 | FOR NZL | CON' CIRC 240V |
| 52 | 300-189 | | 1 | FOR GBR | CON' CIRC 127V |
| 52 | 300-365 | | 1 | FOR USA | CON' CIRC 127V |
| 53 | 959-141 | VERBINDER 50092 (10ST) DIV.TYPEN | 1 | FOR EUROPE,NZL | CON. 50092 |
| 54 | | | 1 | | NAM |
| 55 | 500-234Z | ANSCHLUSSKABEL MIT STECKER | 1 | (CORD ARMOR D8.8) FOR ITA,FRG,FRA,HOL, | COR |
| | | | 0 | DEN,FIN,SWE,AUT,NOR | |
| 55 | 500-395Z | | 1 | (CORD ARMOR D8.8) FOR SUI | COR |
| 55 | 500-439Z | | 1 | (CORD ARMOR D8.8) FOR NZL | COR |
| 55 | 500-240Z | | 1 | (CORD ARMOR D8.8) FOR USA | COR |
| 55A | 500-435Z | | 1 | (CORD ARMOR D8.8) FOR GBR (240V) | COR |
| 55B | 500-461Z | | 1 | (CORD ARMOR D8.8) FOR GBR (110V) | COR |
| 56 | 981-373 | ADERENDHÜLSE (D) DIV.TYPEN | 2 | FOR CORD | TUBI |
| 57 | 980-063 | KABELSCHUH C7U/CJ65V2/H70SA/G13V | 1 | FOR CORD | TERM |
| 58 | 984-750 | SCHNEIDSCHRAUBE D4X16 MIT FLANSCH | 2 | | TAPF SCRI (W/F D4X1 |
| 59 | 937-631 | KABELKLEMME DIV.TYPEN | 1 | | COR |
| 60 | 953-327 | KABELKNICKSCHUTZ D8.8 DIV.TYPEN | 1 | | COR D8.8 |
| 60 | 938-051 | KABELKNICKSCHUTZ D10.1 DIV.TYPEN | 1 | | COR D10. |
| 501 | 300-177 | STAUBBEUTEL SV12V/SV12SD | 1 | | DUS' |
| 502 | 300-047 | | 1 | (PERFORATED) | SANI PAPE 114X |

| | | | | | |
|-----|---------|---------------------|---|---------|-------|
| | | | | | (10 P |
| 503 | 301-953 | LOCHPLATTE SV12SD/V | 1 | FOR NZL | PUN |