

ELECTRIC TOOL PARTS LIST

■ CIRCULAR SAW
Model FC 7SA

1994 · 3 · 3
(E5)

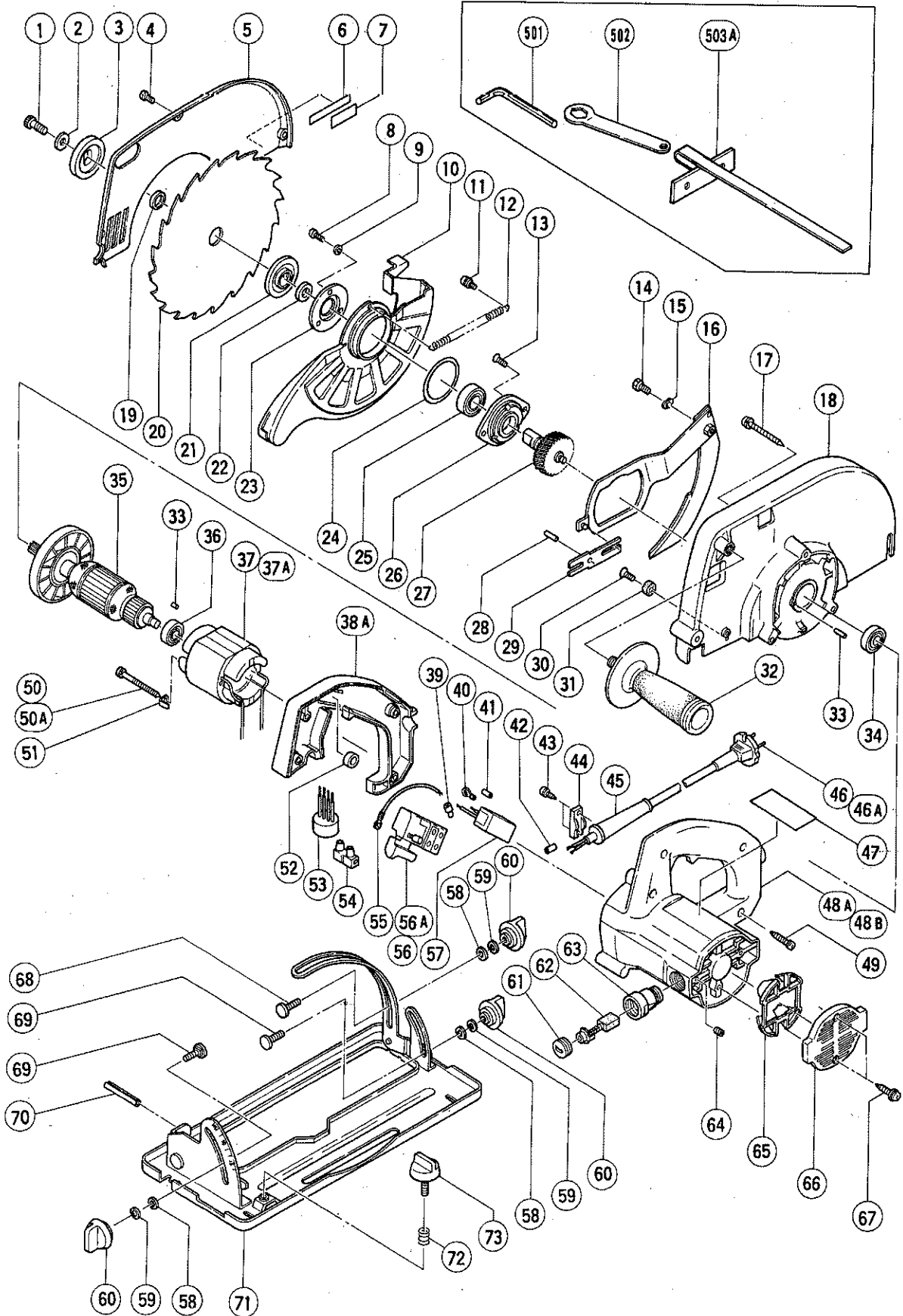

PARTS

FC 7SA

ITEM NO.	CODE NO.	DESCRIPTION	NO. USED	REMARKS
1	963-718Z	HEX. SOCKET HD. BOLT M7X17.5	1	
2	940-845	WASHER	1	
*	3	957-064	1	WASHER (B) (FOR GBR TILL 7.1990)
*	3	940-841	1	WASHER (B) FOR AUT,NOR,BEL,NZL,AUS,ITA,FRG,HOL,DEN, FIN,SWE,GBR (SINCE 8.1990)
4	949-215	MACHINE SCREW M4X8 (10 PCS.)	3	
5	958-041Z	SAW COVER	1	
6	957-561	HITACHI LABEL	1	
*	7	958-052Z	1	CAUTION PLATE (ENGLISH)
*	7		1	CAUTION PLATE
8	949-216	MACHINE SCREW M4X10 (10 PCS.)	3	
9	949-453	SPRING WASHER M4 (10 PCS.)	3	
*	10	994-419	1	SAFETY COVER FOR PRODUCT W/RIVING KNIFE
*	10	994-420	1	SAFETY COVER FOR PRODUCT W/O RIVING KNIFE
11	986-723	MACHINE SCREW (W/WASHERS) M4X8	1	
12	958-040	RETURN SPRING	1	
13	949-331	FLAT HD. SCREW M5X10 (10 PCS.)	2	
*	14	949-657	1	HEX. SOCKET HD. BOLT M6X12 (10 PCS.) FOR PRODUCT W/RIVING KNIFE
*	15	948-167	1	SUPER LOCK WASHER M6 FOR PRODUCT W/RIVING KNIFE
*	16	958-050Z	1	ARM FOR PRODUCT W/RIVING KNIFE
17	983-981	TAPPING SCREW (W/SP. WASHER) D5X45	3	
*	18	994-412	1	GEAR COVER (FOR PRODUCT W/RIVING KNIFE)
*	18	994-413	1	GEAR COVER(FOR PRODUCT W/O RIVING KNIFE)
*	19	958-048Z	1	ADAPTER RING D30/I.D19 FOR NZL,AUS,ITA,FRG,HOL,DEN,FIN,SWE,AUT, NOR,BEL,GBR (SINCE 8.1990)
*	19	990-100	1	RING D15.9/I.D14.5 FOR FRA,SUI,GBR (TILL 7.1990)
*	20		1	SAW BLADE (COMBINATION) 190MM -- D20 HOLE
*	20		1	SAW BLADE (COMBINATION) 190MM -- D30 HOLE
*	20	958-112Z	1	TCT SAW BLADE 190MM -- D16 HOLE
*	20	958-111Z	1	TCT SAW BLADE 190MM -- D30 HOLE
*	21	993-598	1	WASHER (A) FOR D19/20 HOLE
*	21	940-840	1	WASHER (A) FOR D30 HOLE FOR NZL,AUS,ITA,FRG,HOL, DEN,FIN,SWE,AUT,NOR,BEL,GBR (SINCE 8.1990)
*	21	990-089	1	WASHER (A) FOR D16 HOLE FOR FRA,SUI,GBR (TILL 7.1990)
*	22	961-366	1	DISTANCE PIECE (FOR GBR TILL 7.1990)
*	22	940-839	1	DISTANCE PIECE FOR ITA,FRG,HOL,DEN,FIN,SWE,AUT,NOR,NZL, AUS,BEL,GBR (SINCE 8.1990)
23	940-868	BEARING CAP	1	
*	24	994-418	1	THRUST WASHER (T0.1)
25	620-2VV	BALL BEARING 6202VVCMP2S	1	
26	940-867	BEARING HOLDER	1	
*	27	957-059	1	SPINDLE GEAR
*	27	990-096	1	SPINDLE GEAR FOR FRA,SUI,GBR (TILL 7.1990)
*	28	949-498	1	ROLL PIN D4X18 (10 PCS.) FOR PRODUCT W/RIVING KNIFE
*	29	958-051Z	1	CONNECTING PLATE FOR PRODUCT W/RIVING KNIFE
30	949-794	FLAT HD. SCREW M6X20 (10 PCS.)	1	
31	961-729	CUSHION	1	
32	956-633	SIDE HANDLE	1	
33	931-701	BEARING LOCK	2	

*: ALTERNATIVE PARTS

PARTS

FC 75A

ITEM NO.	CODE NO.	DESCRIPTION	NO. USED	REMARKS
34	600-1VV	BALL BEARING 6001VVCMP2L	1	
* 35	360-031E	ARMATURE 220V - 230V	1	
* 35	360-031F	ARMATURE 240V	1	
36	608-VVM	BALL BEARING 608VVMC2EPS2L	1	
* 37	340-032E	STATOR 220V - 230V	1	
* 37	340-032F	STATOR 240V	1	
* 37A	340-032G	STATOR 220V - 230V	1	FOR ITA,FRG,FRA,BEL,HOL,DEN,SWE,SUI
* 38A	983-838	HANDLE COVER (MOSS GREEN)	1	
* 39	959-140	CONNECTOR 50091 (10 PCS.)	3	FOR NZL,SUI
* 40	961-419Z	TERMINAL	1	FOR AUT
* 40	983-504	TERMINAL	1	FOR GBR,SAF,ITA,FRG,FRA,HOL,DEN,SWE,NOR, BEL
* 41	981-373	TUBE (D)	2	FOR NOISE SUPPRESSOR
* 42	981-373	TUBE (D)	2	FOR CORD
43	984-750	TAPPING SCREW (W/FLANGE) D4X16	2	
44	937-631	CORD CLIP	1	
* 45	958-049Z	CORD ARMOR D8.2	1	
* 45	940-778	CORD ARMOR D10.7	1	
* 46	500-201Z	CORD	1	(CORD ARMOR D10.7)
* 46	500-223Z	CORD	1	(CORD ARMOR D10.7) FOR SIN,KUW
* 46	500-226Z	CORD	1	(CORD ARMOR D8.2) FOR AUS,NZL,NGU
* 46	500-234Z	CORD	1	(CORD ARMOR D8.2) FOR ITA,FRG,FRA,HOL, DEN,AUT,BEL
* 46	500-245Z	CORD	1	(CORD ARMOR D10.7) FOR SYR
* 46	500-247Z	CORD	1	(CORD ARMOR D10.7) FOR FIN,SWE,NOR
* 46	500-248Z	CORD	1	(CORD ARMOR D10.7) FOR SUI
* 46	958-271Z	CORD	1	(CORD ARMOR D8.2) FOR SAF
* 46A	500-435Z	CORD	1	(CORD ARMOR D8.2) FOR GBR
47		NAME PLATE	1	
* 48A	994-424	HOUSING ASS'Y (MOSS GREEN)	1	INCLUD.50A,63,64
* 48A	994-425	HOUSING ASS'Y (MOSS GREEN)	1	INCLUD.50A,63,64 FOR AUS,ITA,DEN,SWE, NOR,SUI,BEL,GBR
* 48B	994-426	HOUSING ASS'Y (MOSS GREEN)	1	INCLUD.50A,63,64 FOR AUT
49	956-636	TAPPING SCREW (W/WASHER) D4X25	4	
50	994-421	MACHINE SCREW (W/WASHERS) M5X65	2	TILL 7.1987
50A	958-422	TAPPING SCREW D5X85	2	SINCE 8.1987
* 51	993-853	EARTH WASHER D5	1	FOR NOISE SUPPRESSOR
52	940-811	PUSHING HOLDER	1	TILL 1.1987
* 53	955-908	CHOKE COIL	1	FOR NZL
* 54	938-307Z	PILLAR TERMINAL	1	FOR FIN
* 55	994-190	INTERNAL WIRE	1	
* 56	958-400Z	SWITCH (2P PILLAR TYPE) W/O LOCK	1	FOR SUI
* 56	983-756Z	SWITCH (2P PILLAR TYPE) W/SAFETY LOCK	1	FOR FRA
* 56A	987-058	SWITCH (2P PILLAR TYPE) W/LOCK	1	
* 56A	990-744	SWITCH (2P PILLAR TYPE) W/O LOCK	1	FOR NZL,AUS,GBR,SAF,ITA,HOL,NOR,FRG,BEL, DEN,FIN,SWE,AUT
* 57	994-273	NOISE SUPPRESSOR	1	
58	949-425	WASHER M6 (10 PCS.)	3	
59	949-455	SPRING WASHER M6 (10 PCS.)	3	
60	993-842	KNOB NUT M6	3	
* 61	945-161	BRUSH CAP	2	

*: ALTERNATIVE PARTS

