

HITACHI

LIST NO. 0341

ELECTRIC TOOL PARTS LIST

■ ORBITAL SANDER
Model SV 12SD

2000.6.1
(E3-1)

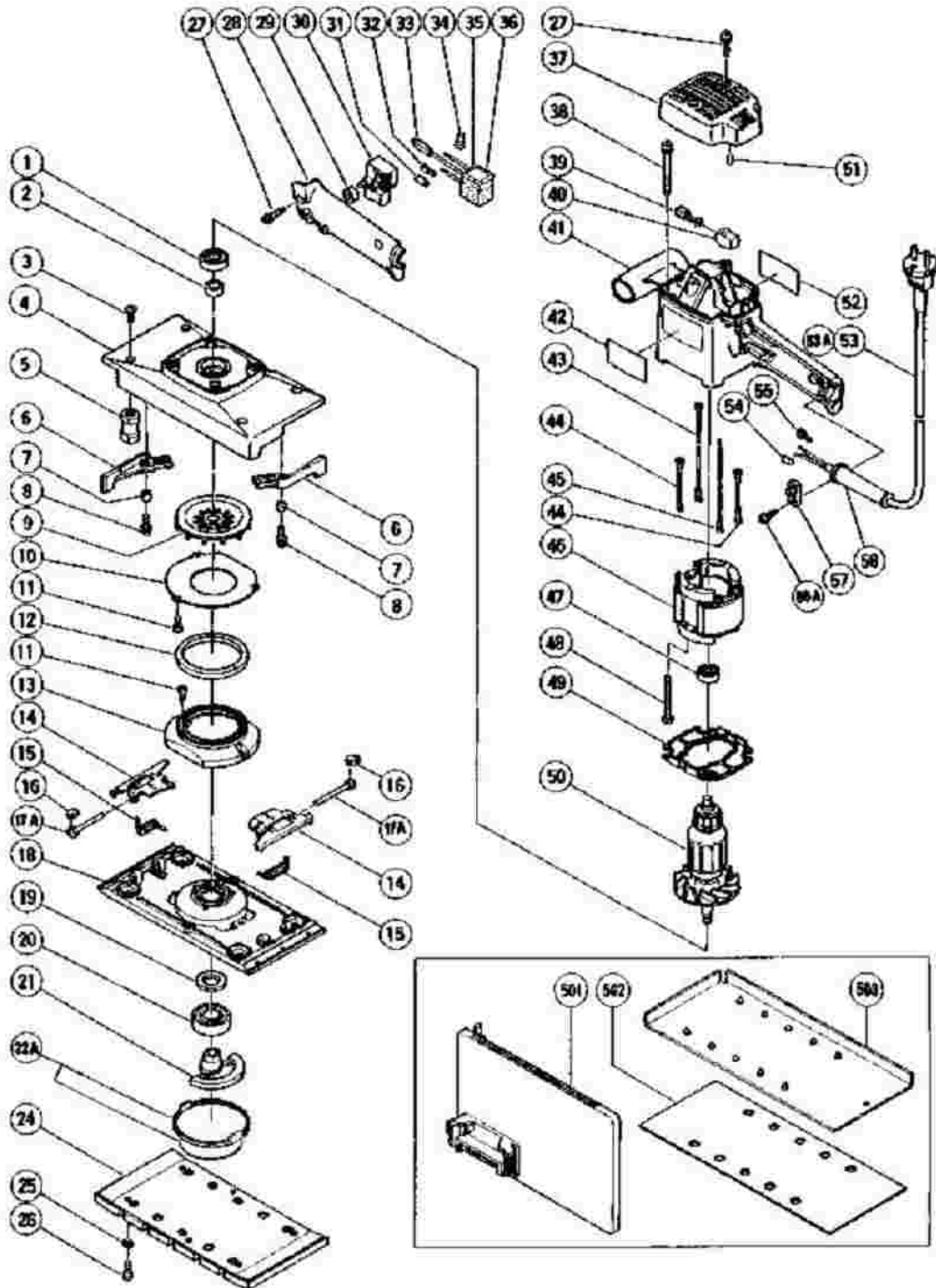

SV12SD

| Pos. Nr. | Art. Nr. | Beschreibung | Stueck | Kommentar |
|----------|----------|-----------------------------------|--------|-------------|
| 1 | 600-1DD | KUGELLAGER 6001 DD | 1 | |
| 2 | 300-158 | BUCHSE SV12V/SV12SD | 1 | |
| 3 | 992-013 | +SENKKOPFSCHRAUBE M5X14 SELBSTSI. | 4 | |
| 4 | 300-172 | RAHMEN SV12V/SV12SD | 1 | |
| 5 | 300-317 | GUMMIFUSS SV12V/SV12SD | 4 | |
| 6 | 300-161 | HEBEL SV12V/SV12SD | 2 | |
| 7 | 953-066 | ABSTANDSTÜCK SV12SD/V/SB110 | 2 | |
| 8 | 993-539 | +KOPFSCHRAUBE M4X16 M.U.SCHEIBE | 2 | |
| 9 | 300-159 | LÜFTER SV12V/SV12SD | 1 | |
| 10 | 300-160 | LUFTFÜHRUNG SV12V/SV12SD | 1 | |
| 11 | 949-216 | +KOPFSCHRAUBE M4X10 (10ST) | 5 | |
| 12 | 300-165 | FILZ (A) SV12V/SV12SD | 1 | |
| 13 | 300-164 | STAUBFÜHRUNG SV12V/SV12SD | 1 | |
| 14 | 300-162 | PAPIERHALTER SV12V/SV12SD | 2 | |
| 15 | 953-320 | FEDER SV12SD/SV12V | 2 | |
| 16 | 872-971 | SICHERUNGSRING (E-TYP) D3 | 2 | TILL 6.1998 |
| 17A | 316-549 | HALTESTAB SV12SD/V | 2 | |
| 18 | 300-173 | GRUNDPLATTE SV12V/SV12SD | 1 | |
| 19 | 300-166 | FILZ SV12V/SV12SD | 1 | |
| | | | | |

| | | | | |
|-----|----------|-----------------------------------|---|----------------------------------|
| 20 | 620-3DD | KUGELLAGER 6203 DD | 1 | |
| 21 | 300-167 | GEGENGEWICHT SV12V/SV12SD | 1 | |
| 22A | 300-318 | DECKEL SV12V/SV12SD | 1 | |
| 24 | 300-090 | SCHLEIFPLATTE GELOCHT SV12V/SD | 1 | |
| 25 | 949-454 | FEDERSCHEIBE M5 (10ST) | 6 | |
| 26 | 949-238 | +KOPFSCHRAUBE M5X14 (10ST) | 6 | |
| 27 | 982-095 | SCHNEIDSCHRAUBE D4X20 M.U-SCHEIBE | 4 | |
| 28 | 300-157 | HANDGRIFFDECKEL SV12V/SV12SD | 1 | |
| 29 | 940-811 | HALTER SV12V/SV12SD | 1 | |
| 30 | 957-747 | SCHALTER CR10V/CR12V/u.a. | 1 | |
| 30 | 971-667Z | SCHALTER CM6/CR10V/CR12V/D13/u.a. | 1 | |
| 31 | 981-373 | ADERENDHÜLSE (D) DIV.TYPEN | 2 | FOR NOISE SUPPRESSOR |
| 32 | 980-063 | KABELSCHUH C7U/CJ65V2/H70SA/G13V | 1 | FOR NOISE SUPPRESSOR |
| 33 | 992-635 | ERDKLEMME DW15Y/SV12V u.a. | 1 | FOR NOISE SUPPRESSOR |
| 34 | 959-140 | VERBINDER 50091 (10ST) DIV.TYPEN | 1 | |
| 35 | 994-273 | KONDENSATOR DIV.TYPEN | 1 | |
| 36 | 930-153 | POLSTER (B) SELBSTKLEB. DIV.TYPEN | 1 | FOR NOISE SUPPRESSOR |
| 36 | 963-243 | POLSTER (SELBSTKLEBEND) DIV.TYPEN | 1 | FOR NOISE SUPPRESSOR FOR NZL,SAF |
| 37 | 300-156 | ENDDECKEL SV12SD | 1 | |
| 38 | 300- | +KOPFSCHRAUBE M5X60 | 4 | |

| | | | | |
|----|----------|-----------------------------------|---|--|
| | 319 | | | |
| 39 | 999-041 | KOHLLENBÜRSTEN (PAAR) | 2 | |
| 40 | 930-483 | KOHLLENHALTER DW15Y/W6VA1 u.a. | 2 | |
| 41 | 300-154 | GEHÄUSE SV12V/SV12SD | 1 | |
| 42 | 300-174 | "AUFKLEBER ""HITACHI"" SV12SD" | 1 | |
| 43 | 300-179 | VERBINDERKABEL SV12V/SV12SD | 1 | |
| 43 | 300-178 | | 1 | FOR AUS |
| 43 | 300-180 | | 1 | FOR USA,CAN |
| 44 | 305-775 | VERBINDERKABEL SV12SD/V | 2 | |
| 44 | 300-205 | | 2 | FOR CAN |
| 44 | 301-843 | | 2 | FOR USA |
| 45 | 300-175 | | 1 | |
| 45 | 300-176 | VERBINDERKABEL SV12SD | 1 | FOR EUROPE |
| 45 | 300-181 | | 1 | FOR AUS |
| 45 | 300-182 | | 1 | FOR USA,CAN |
| 46 | 340-156C | | 1 | |
| 46 | 340-156D | | 1 | |
| 46 | 340-156E | | 1 | |
| 46 | 340-156F | STATOR 230-240V SV12V/SD | 1 | |
| 46 | 340-156G | | 1 | FOR ITA,FRA,AUT |
| 46 | 340-156H | | 1 | FOR GBR,SAF,HOL,DEN,SWE,NOR,ESP,FIN,SUI |
| 46 | 340-156J | | 1 | FOR GBR |
| 47 | 608-VVM | KUGELLAGER 608 VVM | 1 | |

| | | | | |
|-----|----------|-------------------------------------|---|---|
| 48 | 953-174 | SCHNEIDSCHRAUBE D5X55 | 2 | |
| 49 | 300-155 | LUFTFÜHRUNG SV12SV/SV12SD | 1 | |
| 50 | 360-124U | | 1 | INCLUD.1,47 |
| 50 | 360-124D | | 1 | |
| 50 | 360-124E | ANKER 220V-230V SV12V/SD | 1 | |
| 50 | 360-124F | | 1 | FOR SIN,KUW,NGU,NZL,AUS,SAF |
| 51 | 946-362 | LAGERVERRIEGELUNG (DIV.TYPEN) | 2 | |
| 52 | | | 1 | |
| 53 | 500-212Z | | 1 | (CORD ARMOR D8.8) |
| 53 | 500-409Z | ANSCHLUSSKABEL MIT STECKER | 1 | (CORD ARMOR D8.8) FOR INA |
| 53 | 500-245Z | | 1 | (CORD ARMOR D10.1) FOR ESP |
| 53 | 500-237Z | | 1 | (CORD ARMOR D8.8) FOR GBR (110V) |
| 53 | 500-240Z | | 1 | (CORD ARMOR D8.8) FOR USA,CAN |
| 53 | 500-420Z | | 1 | (CORD ARMOR D8.8) FOR SAU (127V) |
| 53 | 500-234Z | ANSCHLUSSKABEL MIT STECKER | 1 | (CORD ARMOR D8.8) FOR ITA,FRG,FRA,HOL, |
| | | | 0 | DEN,FIN,SWE,AUT,NOR,SAF |
| 53 | 500-395Z | | 1 | (CORD ARMOR D8.8) FOR SUI |
| 53 | 500-439Z | | 1 | (CORD ARMOR D8.8) FOR NGU,NZL,AUS |
| 53A | 500-435Z | | 1 | (CORD ARMOR D8.8) FOR GBR (240V) |
| 53A | 500-447Z | | 1 | (CORD ARMOR D8.8) FOR SYR |
| 53A | 500-423Z | | 1 | (CORD ARMOR D8.8) FOR SIN,KUW,SAU (220V) |
| 54 | 981-373 | ADERENDHÜLSE (D) DIV.TYPEN | 2 | FOR CORD |
| 55 | 980-063 | KABELSCHUH C7U/CJ65V2/H70SA/G13V | 1 | FOR CORD |
| | | | | |

| | | | | |
|-----|---------|--------------------------------------|---|--------------|
| 56A | 305-812 | SCHNEIDSCHRAUBE D4X16 MIT FLANSCH | 2 | |
| 57 | 937-631 | KABELKLEMME DIV.TYPEN | 1 | |
| 58 | 953-327 | KABELKNICKSCHUTZ D8.8 DIV.TYPEN | 1 | |
| 58 | 938-051 | KABELKNICKSCHUTZ D10.1 DIV.TYPEN | 1 | |
| 501 | 300-177 | STAUBBEUTEL SV12V/SV12SD | 1 | |
| 502 | 300-047 | | 1 | (PERFORATED) |
| 503 | 301-953 | LOCHPLATTE SV12SD/V | 1 | FOR AUS |